

# FAST GUIDE

**1** Attach silicon border to mask

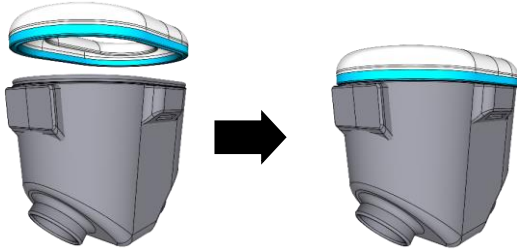

**2** Attach outlet valve

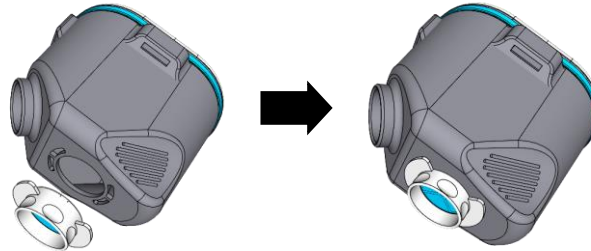

## WARNING

**DO NOT USE ALCOHOL OR SOLVENT TO CLEAN THE EQUIPMENT**

**USE A MULTI-SURFACE DESINFECTANT AND RINSE UNDER THE TAP**

**3** Place the liquid to be nebulized inside the cup



**4** Connect the cup to the controller

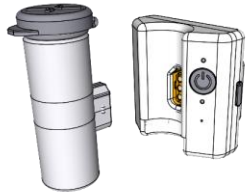

**Make sure the device is turned off**

**5** Attach the inlet valve

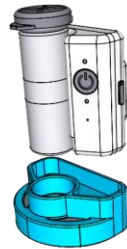

**6** Attach the aerosol chamber

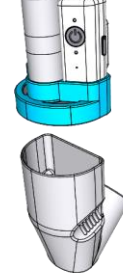

Correctly assembled nebulizer set



**USE DISTILLED WATER AND A FEW DROPS OF DETERGENT TO CLEAN THE CUP**

**7** Place the mask on the horse and adjust the strap

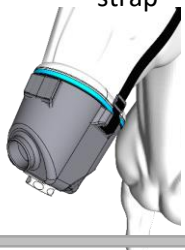

**8** Turn on by pressing and releasing the gray button

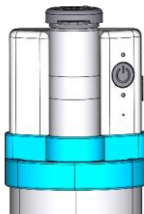

**9** Attach the nebulizer set to the mask

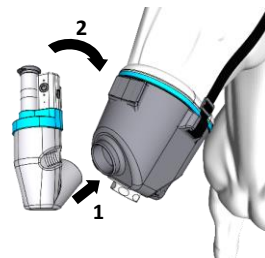

If the equipment is on and does not generate aerosol, check that no liquid drops have accumulated at the bottom of the cup. Dry with a paper napkin or cotton swab.

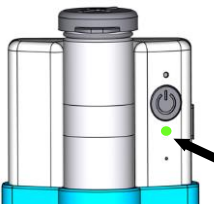
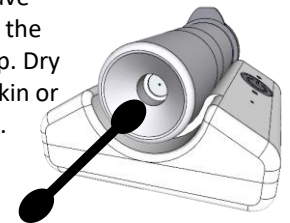

- Green led on indicates equipment running and battery charged.
- Green led flashing every one second indicates low battery.
- Green led flashing quickly and turning off, indicates empty battery. Charge needed.

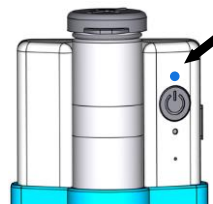

- Blue led flashes every one second for four times and the device turns off, indicating cup out of liquid.
- Blue led flashing quickly and the device turns off, indicating disconnected, loose or damaged cup.
- Blue led flashes quickly every two seconds and the device is on, indicating turbo mode activated.

simpleneb

